

KARTA TECHNICZNA

NAROŻNIK ZEWNĘTRZNY

P-PRA

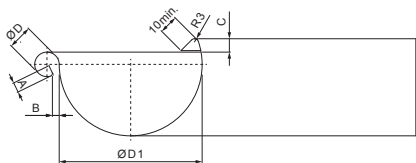

Ocynkowana stal powlekana – Niebieski ciemny – RAL 5010

| Wymiary [mm] | | | | | | |
|-------------------|-----|-----|--------|------|---------|-----|
| Rozmiar nominalny | A±1 | B±1 | C min. | ØD±1 | ØD1+2/0 | L±1 |
| 200 | 5 | 5 | 8 | 16 | 80 | 255 |
| 250 | 7 | 5 | 10 | 18 | 105 | 280 |
| 280 | 7 | 6 | 11 | 18 | 127 | 300 |
| 333 | 9 | 6 | 11 | 20 | 153 | 300 |
| 400 | 9 | 6 | 11 | 22 | 192 | 345 |

| | | | | | | |
|-----------------------|--------|----------|--------|------------------------|------------------------|--------|
| INDEKS | ZMIANA | DATA | PODPIS | KJG QUALITY® | Scan code for 3D model | |
| ZIN. MAT | | | K.O. | MASA kg | SKALA | |
| WYM. PÓLT. | | | | Norma STN | | NR KL. |
| SPORZ. Ing. Kluska M. | | | | ZMIAN. | NR POL. | |
| SPRAW. | | | | STARY RYS. | NR RYS. | |
| TECHNOL. | | TECHNOL. | | | | |
| NAZWA | | | | Liczba arkuszy | | |
| Narożnik zewnętrzny | | | | P-PRA | | |
| | | | | Arkusze | | |

Utworzone: 07.06.2026 09:00:07

Zmiany techniczne zastrzeżone