

KARTA TECHNICZNA

NAROŻNIK ZEWNĘTRZNY

P-PRA

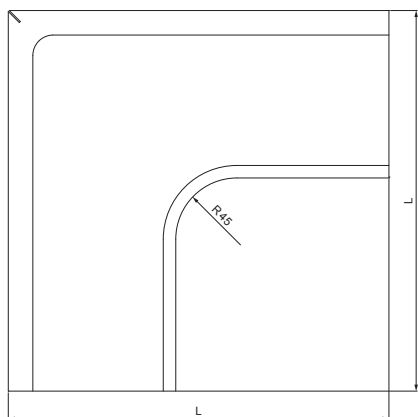
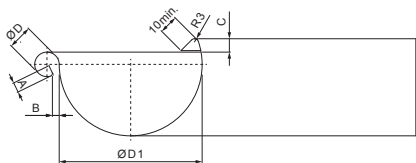

MZ Ocynkowana stal powlekana – Zielony mech – RAL 6005

| Wymiary [mm] | | | | | | |
|-------------------|-----|-----|--------|------|---------|-----|
| Rozmiar nominalny | A±1 | B±1 | C min. | ØD±1 | ØD1+2/0 | L±1 |
| 200 | 5 | 5 | 8 | 16 | 80 | 255 |
| 250 | 7 | 5 | 10 | 18 | 105 | 280 |
| 280 | 7 | 6 | 11 | 18 | 127 | 300 |
| 333 | 9 | 6 | 11 | 20 | 153 | 300 |
| 400 | 9 | 6 | 11 | 22 | 192 | 345 |

| | | | | | | |
|------------|---------------------|------|----------------|------------------------|------------------------|--|
| INDEKS | ZMIANA | DATA | PODPIS | KJG QUALITY® | Scan code for 3D model | |
| ZN. MAT. | K.O. | | MASA kg | SKALA | | |
| WYM. PÓLT. | | | Norma STN | NR KL. | | |
| SPORZ. | Ing. Kluska M. | | ZMIAN. | NR POL. | | |
| SPRAW. | | | STARY RYS. | NR RYS. | | |
| TECHNOL. | TECHNOL. | | | | | |
| NAZWA | Narożnik zewnętrzny | | Liczba arkuszy | P-PRA | Arkusz | |

Utworzone: 21.04.2026 23:55:14

Zmiany techniczne zastrzeżone