

KARTA TECHNICZNA

WYLOT KWADRATOWY

PH-PKLH

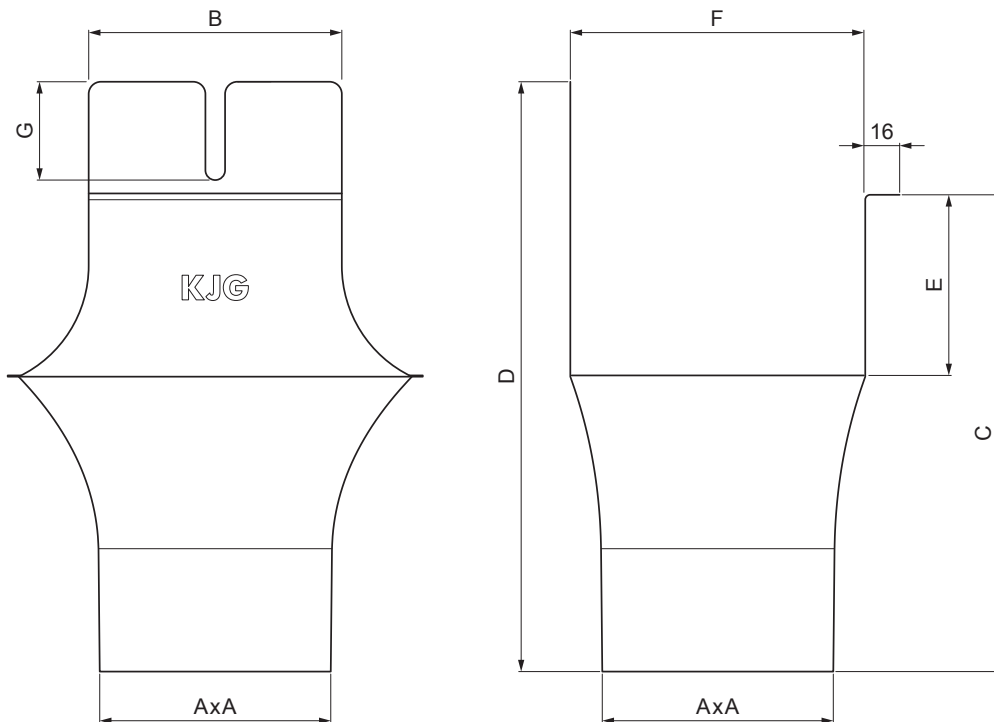

IC Ocynkowana stal powlekana – Czarny – RAL 9005

| Wymiary [mm] | | | | | | | |
|-------------------|---------|-----|-----|-----|----|-----|----|
| Rozmiar nominalny | AxA | B | C | D | E | F | G |
| 250-80/80 | 80x80 | 80 | 138 | 180 | 41 | 85 | 50 |
| 333-80/80 | 80x80 | 103 | 176 | 240 | 58 | 120 | 40 |
| 333-100/100 | 100x100 | 103 | 176 | 240 | 58 | 120 | 40 |
| 400-100/100 | 100x100 | 113 | 207 | 272 | 73 | 150 | 57 |
| 400-120/120 | 120x120 | 130 | 207 | 276 | 73 | 150 | 50 |
| 500-150/150 | 150x150 | 165 | 288 | 373 | 93 | 200 | 60 |

| | | | | | | |
|------------|------------------|------|--------|------------------------|------------------------|--------------------|
| INDEKS | ZMIANA | DATA | PODPIS | KJG QUALITY® | Scan code for 3D model | |
| ZN. MAT. | | | | K.O. | MASA kg | SKALA |
| WYM. PÓLT. | | | | | | |
| POM. URZ. | | | | | Norma STN | NR KL. |
| SPORZ. | Ing. Kluska M. | | | | ZMIAN. | NR POL. |
| SPRAW. | | | | | | |
| TECHNOL. | TECHNOL. | | | | STARY RYS. | NR RYS. |
| NAZWA | Wylot kwadratowy | | | | Liczba arkuszy | PH-PKLH Arkusze |

Utworzone: 04.06.2026 02:26:39

Zmiany techniczne zastrzeżone